

## Eco-Modul 40 Signal tower

- Ø 40 mm modular signal tower series
- Complete range of high-luminosity LED light modules with
- steady/flashing/strobe and multi-strobe beacon functions, 6 different lens colours
- Alternatively operated with conventional incandescent bulb technology
- Piezo buzzer module available with steady/pulsing tone
- Pre-assembled towers or individual tower modules available for configuration
- Extensive range of mounting types
- User-friendly connection technology
- PLC-suitable
- High degree of protection IP66, UL type 4/4X/13

### TECHNICAL DATA

Housing	Ø 40 mm, Polycarbonate black
Lens	Polycarbonate, ribbed inside orange, red, clear, blue, green or yellow
Type of mounting	any
Connection technology	up to 1,5mm <sup>2</sup> / 16 AWG
Leakage current	> 0,003 A (PLC-suitable)
Beacon type	LED steady beacon, LED flashing beacon, LED strobe beacon, LED multi strobe beacon or Steady beacon (incandescent bulb)
Light source	8 LEDs, incandescent bulb
Strobe/flash frequency	Flashing beacon 2 Hz, strobe beacon 1.4 Hz, multi strobe beacon 1-2.6 Hz
Tone	Steady tone or Pulsing tone
Volume	80 dB
Tone frequency	4.000 Hz
Duty cycle	100 %
Service life	Light source: LED 100,000 hours
Number of possible modules	max. 5, with double bracket max. 10
Operating temperature	-30 °C / +60 °C
Degree of protection	IP66 & UL Type 4/4x/13
Weight (modules)	40-46 g



# Eco-Modul 40 Pre-configured Signal towers



Modular



Order number: ECO40-Q01  
Colours: red/orange/green  
Function: LED steady beacon  
Nominal voltage: 24 V AC/DC  
Type of mounting: Tube mounting  
 (100 mm tube length)



Order number: ECO40-Q02  
Colours: red/green  
Function: LED steady beacon  
Nominal voltage: 24 V AC/DC  
Type of mounting: Tube mounting  
 (100 mm tube length)



Order number: ECO40-Q05  
Colours: red/orange/green/blue  
Function: LED steady beacon  
Nominal voltage: 24 V AC/DC  
Type of mounting: Tube mounting  
 (100 mm tube length)



Order number: ECO40-Q31  
Colours: red/orange/green  
Function: LED steady beacon, buzzer  
 steady or pulsing tone  
Nominal voltage: 24 V AC/DC  
Type of mounting: Tube mounting  
 (100 mm tube length)



Order number: ECO40-Q81  
Colours: red/orange/green  
Function: LED steady beacon, buzzer  
 steady or pulsing tone  
Nominal voltage: 230 V AC  
Type of mounting: Tube mounting  
 (100 mm tube length)

# Eco-Modul 40

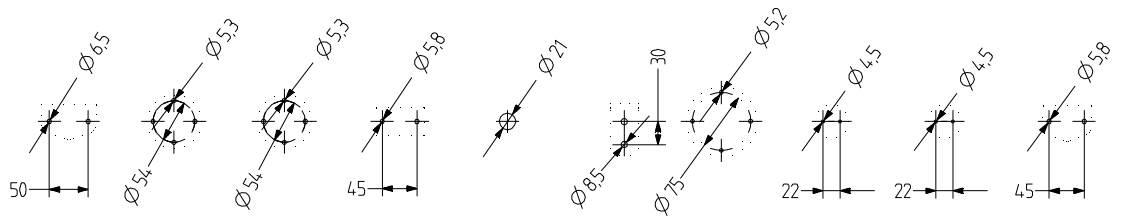
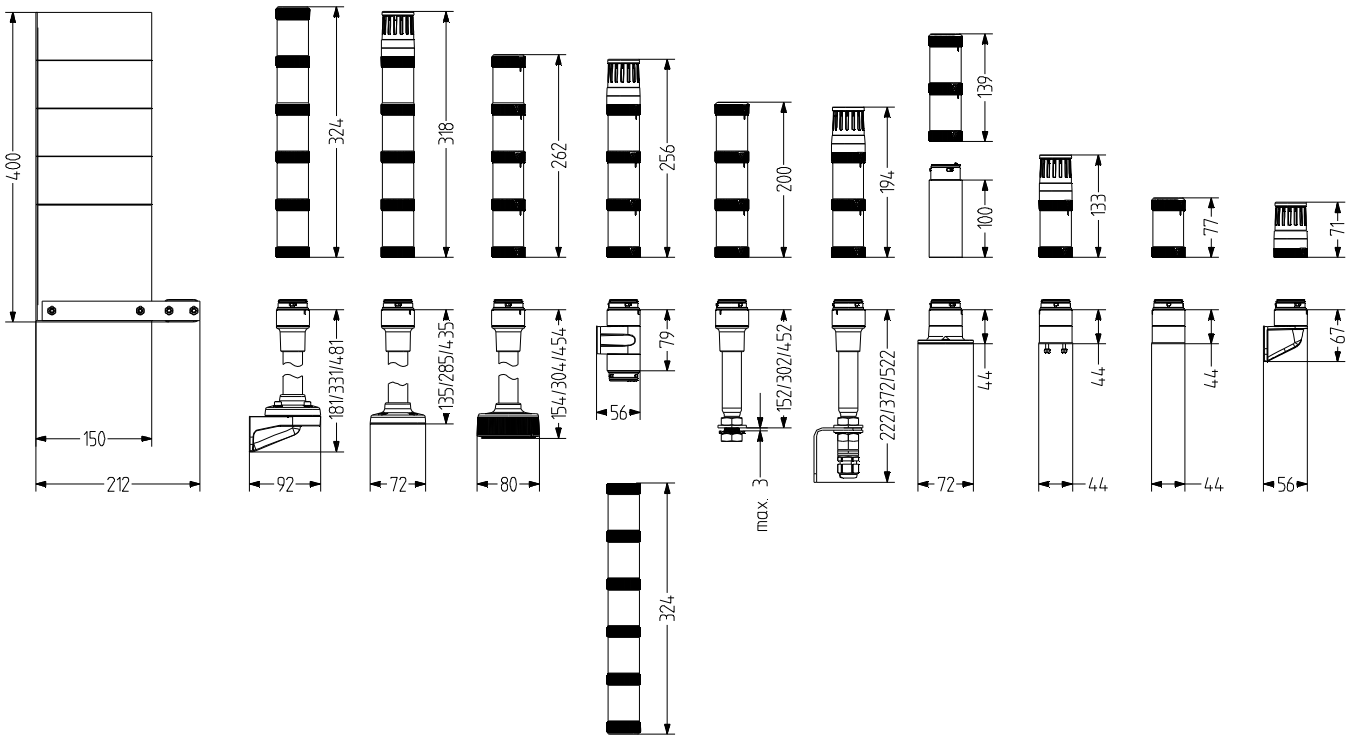

# Eco-Modul 40



Modular

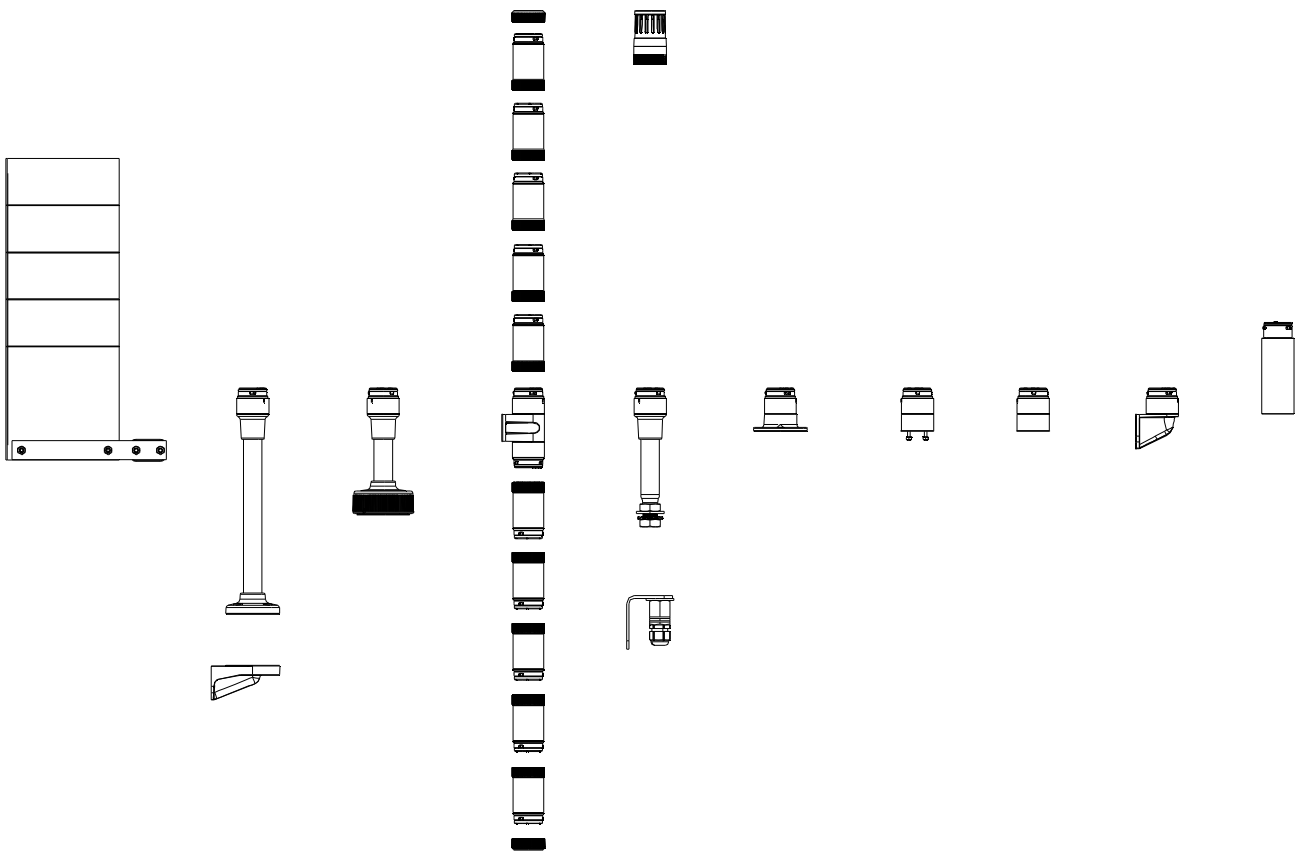

# Eco-Modul 40

## VISUAL MODULES

Type	Beacon type	Lens colour	Nominal voltage	Voltage range [V]	Nominal current [A]	Order number	Item Nr.		
ZLL	Steady beacon	orange	12-250 V AC/DC	+/- 10 %	4 W	902 001 900	902 001 900		
		red	12-250 V AC/DC	+/- 10 %	4 W	902 002 900	902 002 900		
		clear	12-250 V AC/DC	+/- 10 %	4 W	902 004 900	902 004 900		
		blue	12-250 V AC/DC	+/- 10 %	4 W	902 005 900	902 005 900		
		green	12-250 V AC/DC	+/- 10 %	4 W	902 006 900	902 006 900		
		yellow	12-250 V AC/DC	+/- 10 %	4 W	902 007 900	902 007 900		
ZDC	LED steady beacon	orange	24 V AC/DC	+/- 10 %	0,022-0,033	902 011 405	902 011 405		
			110-120 V AC	+/- 10 %	0,030	902 011 310	902 011 310		
			230-240 V AC	+/- 10 %	0,030	902 011 313	902 011 313		
		red	24 V AC/DC	+/- 10 %	0,022-0,033	902 012 405	902 012 405		
			110-120 V AC	+/- 10 %	0,030	902 012 310	902 012 310		
			230-240 V AC	+/- 10 %	0,030	902 012 313	902 012 313		
		clear	24 V AC/DC	+/- 10 %	0,022-0,033	902 014 405	902 014 405		
			110-120 V AC	+/- 10 %	0,030	902 014 310	902 014 310		
			230-240 V AC	+/- 10 %	0,030	902 014 313	902 014 313		
		blue	24 V AC/DC	+/- 10 %	0,022-0,033	902 015 405	902 015 405		
			110-120 V AC	+/- 10 %	0,030	902 015 310	902 015 310		
			230-240 V AC	+/- 10 %	0,030	902 015 313	902 015 313		
		green	24 V AC/DC	+/- 10 %	0,022-0,033	902 016 405	902 016 405		
			110-120 V AC	+/- 10 %	0,030	902 016 310	902 016 310		
			230-240 V AC	+/- 10 %	0,030	902 016 313	902 016 313		
		yellow	24 V AC/DC	+/- 10 %	0,022-0,033	902 017 405	902 017 405		
			110-120 V AC	+/- 10 %	0,030	902 017 310	902 017 310		
			230-240 V AC	+/- 10 %	0,030	902 017 313	902 017 313		
		ZDA	LED flashing beacon	orange	24 V AC/DC	+/- 10 %	0,028-0,036	902 021 405	902 021 405
					110-120 V AC	+/- 10 %	0,030	902 021 310	902 021 310
					230-240 V AC	+/- 10 %	0,030	902 021 313	902 021 313
				red	24 V AC/DC	+/- 10 %	0,028-0,036	902 022 405	902 022 405
					110-120 V AC	+/- 10 %	0,030	902 022 310	902 022 310
					230-240 V AC	+/- 10 %	0,030	902 022 313	902 022 313
clear	24 V AC/DC			+/- 10 %	0,028-0,036	902 024 405	902 024 405		
	110-120 V AC			+/- 10 %	0,030	902 024 310	902 024 310		
	230-240 V AC			+/- 10 %	0,030	902 024 313	902 024 313		
blue	24 V AC/DC			+/- 10 %	0,028-0,036	902 025 405	902 025 405		
	110-120 V AC			+/- 10 %	0,030	902 025 310	902 025 310		
	230-240 V AC			+/- 10 %	0,030	902 025 313	902 025 313		
green	24 V AC/DC			+/- 10 %	0,028-0,036	902 026 405	902 026 405		
	110-120 V AC			+/- 10 %	0,030	902 026 310	902 026 310		
	230-240 V AC			+/- 10 %	0,030	902 026 313	902 026 313		
yellow	24 V AC/DC			+/- 10 %	0,028-0,036	902 027 405	902 027 405		
	110-120 V AC			+/- 10 %	0,030	902 027 310	902 027 310		
	230-240 V AC			+/- 10 %	0,030	902 027 313	902 027 313		

## Eco-Modul 40

## VISUAL MODULES

Type	Beacon type	Lens colour	Nominal voltage	Voltage range (V)	Nominal current (A)	Order number	Item Nr.	
ZDF	LED strobe beacon	orange	24 V AC/DC	+/- 10 %	0,035-0,065	902 031 405	902 031 405	
			110-120 V AC	+/- 10 %	0,010	902 031 310	902 031 310	
			230-240 V AC	+/- 10 %	0,010	902 031 313	902 031 313	
		red	24 V AC/DC	+/- 10 %	0,035-0,065	902 032 405	902 032 405	
			110-120 V AC	+/- 10 %	0,010	902 032 310	902 032 310	
			230-240 V AC	+/- 10 %	0,010	902 032 313	902 032 313	
		clear	24 V AC/DC	+/- 10 %	0,035-0,065	902 034 405	902 034 405	
			110-120 V AC	+/- 10 %	0,010	902 034 310	902 034 310	
			230-240 V AC	+/- 10 %	0,010	902 034 313	902 034 313	
	blue	24 V AC/DC	+/- 10 %	0,035-0,065	902 035 405	902 035 405		
		110-120 V AC	+/- 10 %	0,010	902 035 310	902 035 310		
		230-240 V AC	+/- 10 %	0,010	902 035 313	902 035 313		
	green	24 V AC/DC	+/- 10 %	0,035-0,065	902 036 405	902 036 405		
		110-120 V AC	+/- 10 %	0,010	902 036 310	902 036 310		
		230-240 V AC	+/- 10 %	0,010	902 036 313	902 036 313		
	yellow	24 V AC/DC	+/- 10 %	0,035-0,065	902 037 405	902 037 405		
		110-120 V AC	+/- 10 %	0,010	902 037 310	902 037 310		
		230-240 V AC	+/- 10 %	0,010	902 037 313	902 037 313		
	ZFF	LED multi strobe beacon	orange	24 V AC/DC	+/- 10 %	0,048-0,068	902 041 405	902 041 405
				110-120 V AC	+/- 10 %	0,021-0,030	902 041 310	902 041 310
				230-240 V AC	+/- 10 %	0,021-0,030	902 041 313	902 041 313
			red	24 V AC/DC	+/- 10 %	0,048-0,068	902 042 405	902 042 405
				110-120 V AC	+/- 10 %	0,021-0,030	902 042 310	902 042 310
				230-240 V AC	+/- 10 %	0,021-0,030	902 042 313	902 042 313
			clear	24 V AC/DC	+/- 10 %	0,048-0,068	902 044 405	902 044 405
				110-120 V AC	+/- 10 %	0,021-0,030	902 044 310	902 044 310
				230-240 V AC	+/- 10 %	0,021-0,030	902 044 313	902 044 313
blue		24 V AC/DC	+/- 10 %	0,048-0,068	902 045 405	902 045 405		
		110-120 V AC	+/- 10 %	0,021-0,030	902 045 310	902 045 310		
		230-240 V AC	+/- 10 %	0,021-0,030	902 045 313	902 045 313		
green		24 V AC/DC	+/- 10 %	0,048-0,068	902 046 405	902 046 405		
		110-120 V AC	+/- 10 %	0,021-0,030	902 046 310	902 046 310		
		230-240 V AC	+/- 10 %	0,021-0,030	902 046 313	902 046 313		
yellow		24 V AC/DC	+/- 10 %	0,048-0,068	902 047 405	902 047 405		
		110-120 V AC	+/- 10 %	0,021-0,030	902 047 310	902 047 310		
		230-240 V AC	+/- 10 %	0,021-0,030	902 047 313	902 047 313		



Modular

# Eco-Modul 40

## AUDIBLE MODULES

Type	Tone	Volume	Nominal voltage	Voltage range [V]	Nominal current [A]	Order number
ZDE	Piezo buzzer module steady tone/pulsing tone	80 dB	24 V AC/DC	+/- 10 %	0,039	902 500 405
			110-120 V AC	+/- 10 %	0,021	902 500 310
			230-240 V AC	+/- 10 %	0,021	902 500 313

## ORDER DATA - BASE

Type	Type of accessory	Tube length	Item Nr.
ZMW	Base for horizontal mounting M20, inside mounting holes		902 570 900
ZMS	Base for horizontal mounting with pre-mounted fixing screws		902 571 900
ZMF	Base for horizontal mounting with external mounting holes		902 572 900
ZMC	Base for horizontal mounting with external mounting holes and integrated 5-pole M12 connector		902 572 911
ZMV	Base for vertical mounting for single-sided mounting		902 573 900
ZZV	Base for vertical mounting for double-sided mounting		902 574 900
ZMR	Tube base 100 mm on aluminium tube with plastic foot	100 mm	902 582 900
	Tube base 250 mm on aluminium tube with plastic foot	250 mm	902 583 900
	Tube base 400 mm on aluminium tube with plastic foot	400 mm	902 584 900
ZNW	Tube base NPT 1/2" thread		902 570 950
ZSW	Tube base 100 mm on aluminium tube for horizontal mounting with banjo bolt	100 mm	902 594 900
	Tube base 250 mm on aluminium tube for horizontal mounting with banjo bolt	250 mm	902 592 900
	Tube base 400 mm on aluminium tube for horizontal mounting with banjo bolt	400 mm	902 593 900
ZFR	Quick mounting system 'foot adapter' 100 mm on aluminium tube with foot adapter	100 mm	902 562 900
	Quick mounting system 'foot adapter' 250 mm on aluminium tube with foot adapter	250 mm	902 563 900
	Quick mounting system 'foot adapter' 400 mm on aluminium tube with foot adapter	400 mm	902 564 900



XWR



XSS



XIB



WZC



ZEP

## ACCESSORIES

Type	Type of accessory	Tube length	Weight	Order number
XWR	Bracket for vertical mounting of TMR/UMR tube base		95 g	900 600 900
XSS	Set Set for vertical mounting (bracket, cable gland)		135 g	900 700 900
XIB	Identification plate		235 g	900 850 900
WZC	Bracket		85 g	200 550 900
ZEP	Base extension 100 mm long, suitable for all bases	100 mm		902 800 900